



Outdoor

The SPAX solution
for connecting timber
to steel in DELTA[®]-SEAL.

SPAX Timber To Steel Screw

For wooden decks and walls

The SPAX advantages:

- T-STAR plus recess
- Cylinder head
- Fixing thread

Please see installation tips on back page



SPAX
Step Drill 5
5000009196540



SPAX
Drive Stop
5000009186909



SPAX
Air
4009422545009



The SPAX solution for connecting timber to steel in DELTA®-SEAL

The SPAX Timber-to-Steel Screw for board thicknesses of 16 – 22 mm and 35 – 50 mm. It is ideal for fastening fencing, screening, decking* or fibre cement board to steel joists.

Do not use an impact driver to drive SPAX screws – use a normal drill at high speed.

Step 1 - Pre-drill the timber boards with a SPAX Step-drill 5. There is no need to pre-drill the steel, as the specially designed tip of the Timber-to-Steel Screw will pre-drill steel up to 5mm thick (minimum recommended steel thickness is 1.6mm). Adjust your SPAX Step-drill 5 so that when the tip hits the steel joist, the step bit cuts 1-2mm into the surface of the board. On all horizontal applications eg. decking, make sure to use a SPAX Air Spacer to allow space for timber and metal shavings. The Air Spacer also ensures the timber and steel are not in contact, to prevent corrosion.

Step 2 - Make sure to adjust your SPAX Drive Stop to the appropriate depth. You may need to test this on an offcut. Drive the Timber-to-Steel Screw straight in with a SPAX Drive Stop at high speed (1,000 - 2,500rpm). The SPAX Drive Stop will ensure that all screw heads are driven to the correct depth.

Result - Impeccable visual appearance with minimal splitting. Long-lasting connection with minimum movement due to the fixing thread.

It is important to follow the above steps and to use the recommended system to avoid any screw failures.*Check with your local building authority about fastening timber decking to steel joists.

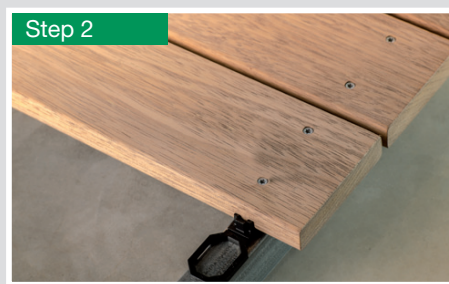
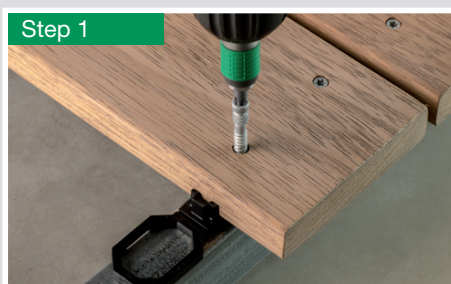

SPAX Cylinder head 5 mm DELTA®- SEAL

Dimensions [mm]					Packaging unit	SPAX-No.
Thread Ø d1	Board Thickness	Length total Ls	Length partial thread LgT	BIT size T	SPAX BOX [pieces]	
5.0 Ø Head = 7.0mm	16 - 22mm	44	20	25	500	35905000802641
	35 - 50mm	71	20	25	350	35905000801641