

The SPAX logo is located in the top right corner. It consists of the word "SPAX" in a bold, white, sans-serif font, followed by a registered trademark symbol (®). The logo is set against a green rectangular background.

Construction Outdoor

SPAX boundary joist and post fixing solution

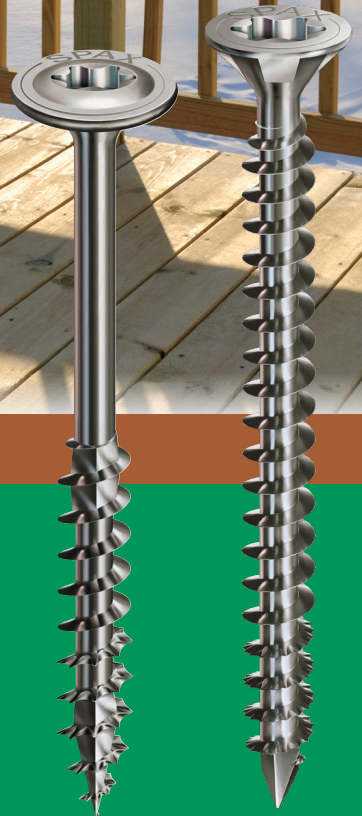

Complies with strength and deflection requirements of NZS 3604 and AS/NZS1170

The SPAX advantages:

- Three times faster installation than other common methods
- PS1 Producer Statement available on request
- No brackets or coach screws required
- Higher load capacity allowing larger baluster spacings
- Exceptional durability with A4/316 stainless steel
- Aesthetically appealing
- Cost effective



Scan this QR Code
for installation
instructions

Complies with strength and deflection
requirements of NZS 3604 and AS/NZS1170



**MADE IN
GERMANY**

SPAX PACIFIC PTY. LTD. · ALTENLOH, BRINCK & CO - GROUP

Australia · PO Box 975 · Gordonvale · QLD 4865 | Phone: 07 4056 2009 | info@spaxpacific.com

New Zealand · PO Box 55104 Eastridge · Auckland 1146 | Phone: 09 570 7447 | info@spaxpacific.co.nz

SPAX boundary joist and post fixing solution

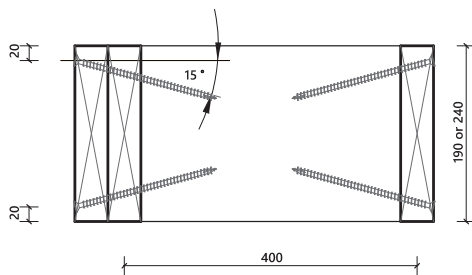
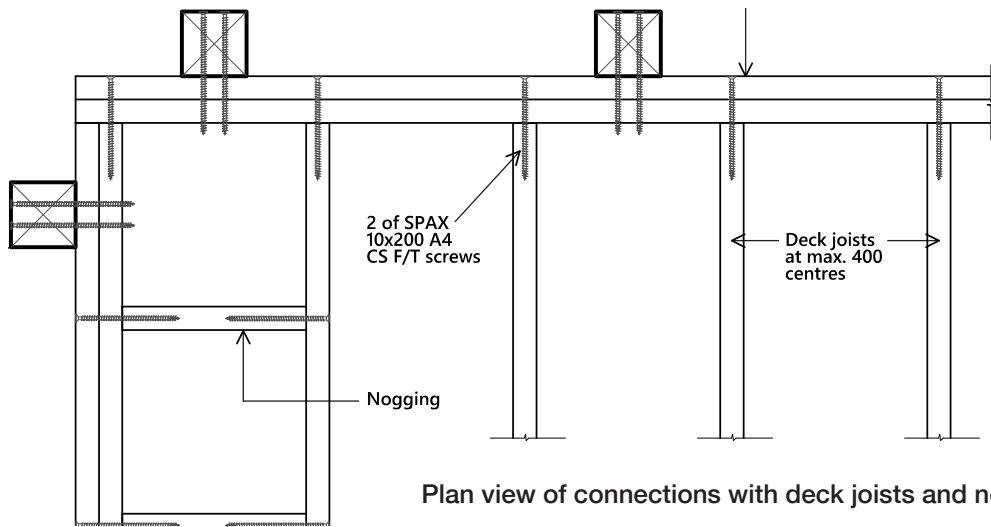



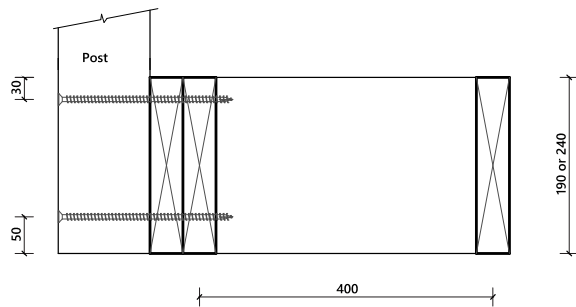

Elevation of boundary joist connection to noggings



Elevation of baluster post connection to boundary joist

SPAX Boundary Joist and Post System*

Item	Description	Drive-Bit Size	SPAX No.	EAN No.
	SPAX 10 x 200 A4 CS F/T	T50	1208001002000	4003530182303
	SPAX 10 x 240 A4 CS. F/T	T50	1208001002400	4003530178689
	SPAX 8 x 120 A2 W/H	T40	0257000801200	4003530242595
	SPAX 8 x 180 A2 W/H	T40	0257000801800	4003530242625
	SPAX Drill-bit Ø 6.0 x 250 HSS-G		2000000250060	4026271029881
	SPAX Boundary Joist Pre-Drill Guide 15°		3000001000015	0794712213543
	SPAX T-STAR plus T40		5000009182409	4003530239687
	SPAX T-STAR T50		5077701515035	4003530161582

* Refer to installation instructions for full details, dimensions and technical information on both face-fixed post and top-fixed post systems.